

## 4 Mounting

<b>A</b>	Code	<b>V</b>				<b>H</b>	
	Motor mounting	Vertical				Horizontal	
<b>B</b>	Code	<b>P</b>	<b>C</b>	<b>M</b>	<b>F</b>	<b>S</b>	
	Air breather Orientation	P,T port Orientation	Cartridge Orientation	Base mounting Orientation	Flank mounting Orientation	Special mounting Orientation	
<b>C</b>	Code	<b>P</b>	<b>C</b>	<b>M</b>	<b>F</b>	<b>S</b>	
	Terminal box (AC) /Start relay (DC) Orientation	P,T port Orientation	Cartridge Orientation	Base mounting Orientation	Flank mounting Orientation	Special mounting Orientation	
<b>D</b>	Code	<b>B</b>				<b>X</b>	
	Bracket	With bracket				Without bracket	

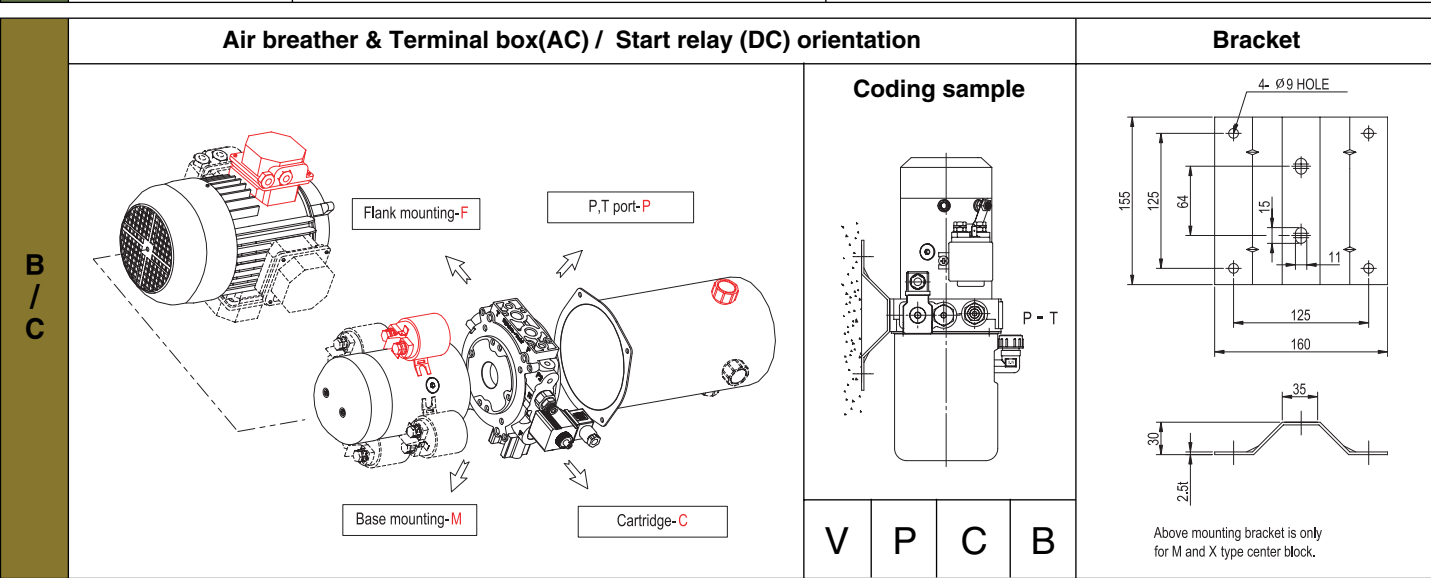

Power pack dimension									
Motor				Tank (M-series)					
Frame (AC) / Voltage (DC)	Watt(Kw) / Code(DC)	A	B	Code	Working cap. (L)	C	D	E	
<b>AC</b>	63Frame	0.18	195	122	MR02	2	185	139	
	70Frame	0.37	220	138	MR05	5	230	190	
	80Frame	0.75	238	157	MR08	8	315	190	
	90Frame	1.0 / 1.5 / 1.8 / 2.2	285	175	MR11	11	450	190	
<b>DC</b>	12V / 24V	D105 / D205, D108 / D208	151	80	MS06	6	140	247	160
	12V / 24V	D112 / D212	140	115	MS09	9	200	200	290
	12V / 24V	D116 / D222	173	112	MS12	12	240	240	306
	12V / 24V	D124 / D230, L116 / L222	227	129	MS25	25	270	280	380
	24V	L230	299	127	MS50	50	430	540	320

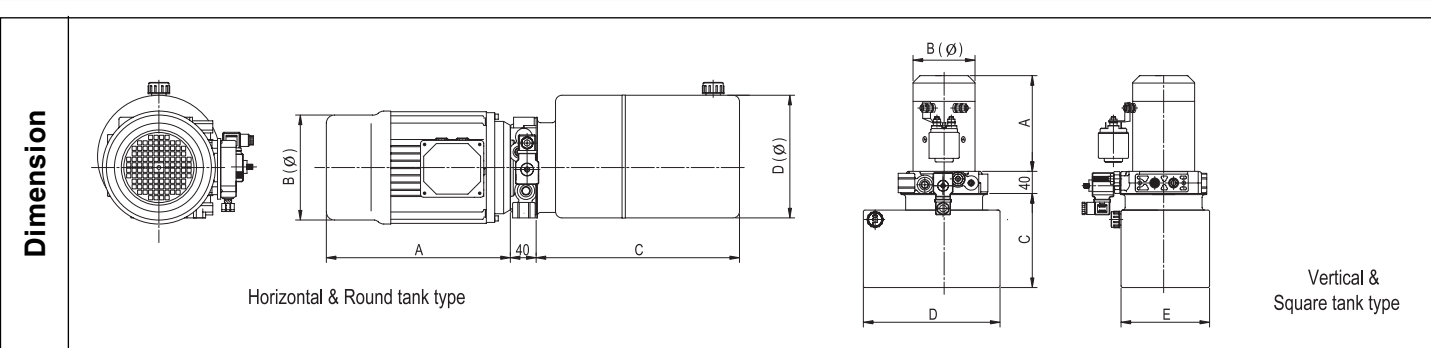

## 5 Tank for M series center block

<b>A</b>	Code	<b>MR</b>										<b>MS</b>										<b>MSLE</b>	<b>XXXX</b>
	Type	M - Series & Round type oil tank										M - Series & Square type oil tank											
<b>B</b>	Code	<b>01</b>	<b>02</b>	<b>03</b>	<b>04</b>	<b>05</b>	<b>06</b>	<b>08</b>	<b>11</b>	<b>04</b>	<b>06</b>	<b>07</b>	<b>09</b>	<b>12</b>	<b>15</b>	<b>20</b>	<b>25</b>	<b>30</b>	<b>50</b>	Only sleeve	Without oil tank		
	Cap. (L)	1	2	3	4	5	6	8	11	4	6	7	9	12	15	20	25	30	50				
	Working cap. (L)	1	1.6	2.2	3	4	5	6	9.5	3	4.5	4.8	7.6	11.7	13	16	22.5	26	48				
	Type	A	A	A	B	B	B	B	B	C	D	E	F	G	G	H	I	J	K				

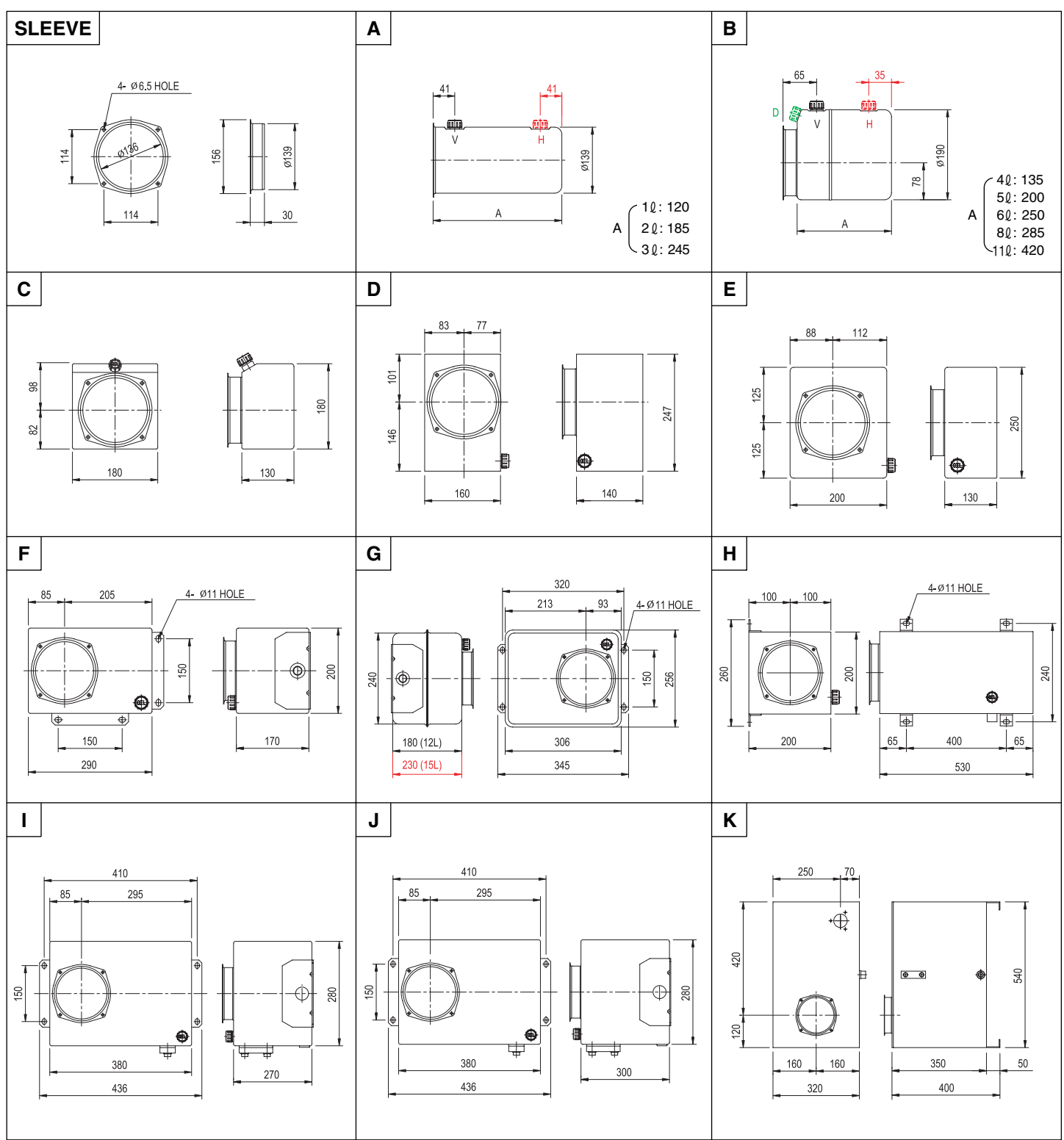

**Note**

- Please contact Hydro-Tek for your special specification and customizing.
- Please inform us the position(D,V or H) of air breather, when you select A or B type oil tank.

