

Pressure limiting valves type CMV and CSV

The types listed are intended for the following purposes:

- **Pressure limiting valve (safety valve):**
Safeguarding the system against excessive pressure or for the limitation of working pressure.
 - **Sequence valves: generating a constant pressure difference between inlet and outlet of the flow. The flow in opposite direction (reflow) is unhindered via a by-pass check valve.**
- A significant advantage of these valves is their easily to manufacture mounting hole (see dimensions).

Type CMV is also available as a pressure limiting valve with unit approval (CE), e.g. required for safety valves for accumulators (EC regulation 97/23). The CE-logo is applied to these valves. Type CMVZ und CSVZ are not influenced by the pressure conditions downstream i.e. sequencing control without losses.



Nomenclature: Pressure limiting valve, sequence valves (directly controlled)

Design: Screw-in valve

Adjustability: Tool adjustable
Manually adjustable

p_{max} : 500 bar

Q_{max} : 60 lpm

Basic types and general parameters

Basic type	CMV/CMVZ	CSV/CSVZ	Symbol	
Function	Pressure limiting valve (port R pressure resistant)	Sequence valves with by-pass check valve	CMV 	CSV
Pressure range:	F: 80	F: 80		
Pressure p_{max} (bar)	E: 160 C: 315 B: 500	E: 160 C: 315 B: 500		
Flow			CMVZ 	CSVZ
Q_{max} (lpm)				
Size 1	20/-	-/-		
Size 2	40/40	40/40		
Size 3	60/-	60/-		

Additional versions

- Connection blocks for pipe connection
- Version with type approval (TÜV) type CMVX, (see also "Additional information")

Order examples

CMV 2 CR - 200

Pressure limiting valve type CMV, size 2, pressure range C (0 to 315 bar), manually adjustable (coding R), adjusted to 200 bar,

CSV 3 F - 60

Sequence valve type CSV, size 3, pressure range F (0 ... 80 bar), tool adjustable (no coding), adjusted to 60 bar

Dimensions

Type CMV/CMVZ

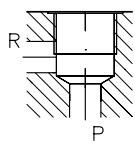
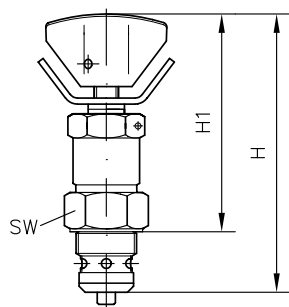

All dimensions in mm, subject to change without notice!

Type CSV/CSVZ

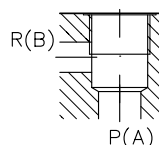
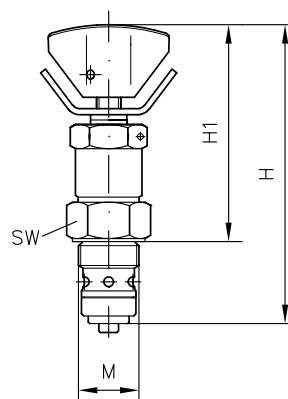

SW = a/f

Size	H _{max}	H1 _{max}	M	SW	m (g)
1	78	57	M 16 x 1.5	a/f 22	90
2	94	72	M 20 x 1.5	a/f 24	160
3	114	83	M 24 x 1.5	a/f 30	275

Size	H _{max}	H1 _{max}	M	SW	m (g)
2	104	73	M 20 x 1.5	a/f 24	150
3	122	82	M 24 x 1.5	a/f 30	300

Additional information

- Pressure limiting valves type CMV, CSV D 7710 MV
- Pressure limiting valves D 7710 TÜV
- with type approval (TÜV) type CMVX
- Pressure limiting valves type MV, SV etc. D 7000/1
- Miniature pressure limiting valves type MVG etc. D 3726

- Piloted pressure valves type DV D 4350
- type A D 6170
- See also section "Devices for special applications"
(Screw-in valves and installation kits, Devices for up to 700 bar)

For page and section of the devices additionally listed, see type index